

PEGGING PLAN

Stage 1 in DA 960/D003/19

in the area named

LYNDOCH

PT CT Volume 6208 Folio 305

Metal Pins (MP) are 1.00m on boundary lines unless shown otherwise.

Peg are shown as thus - ■

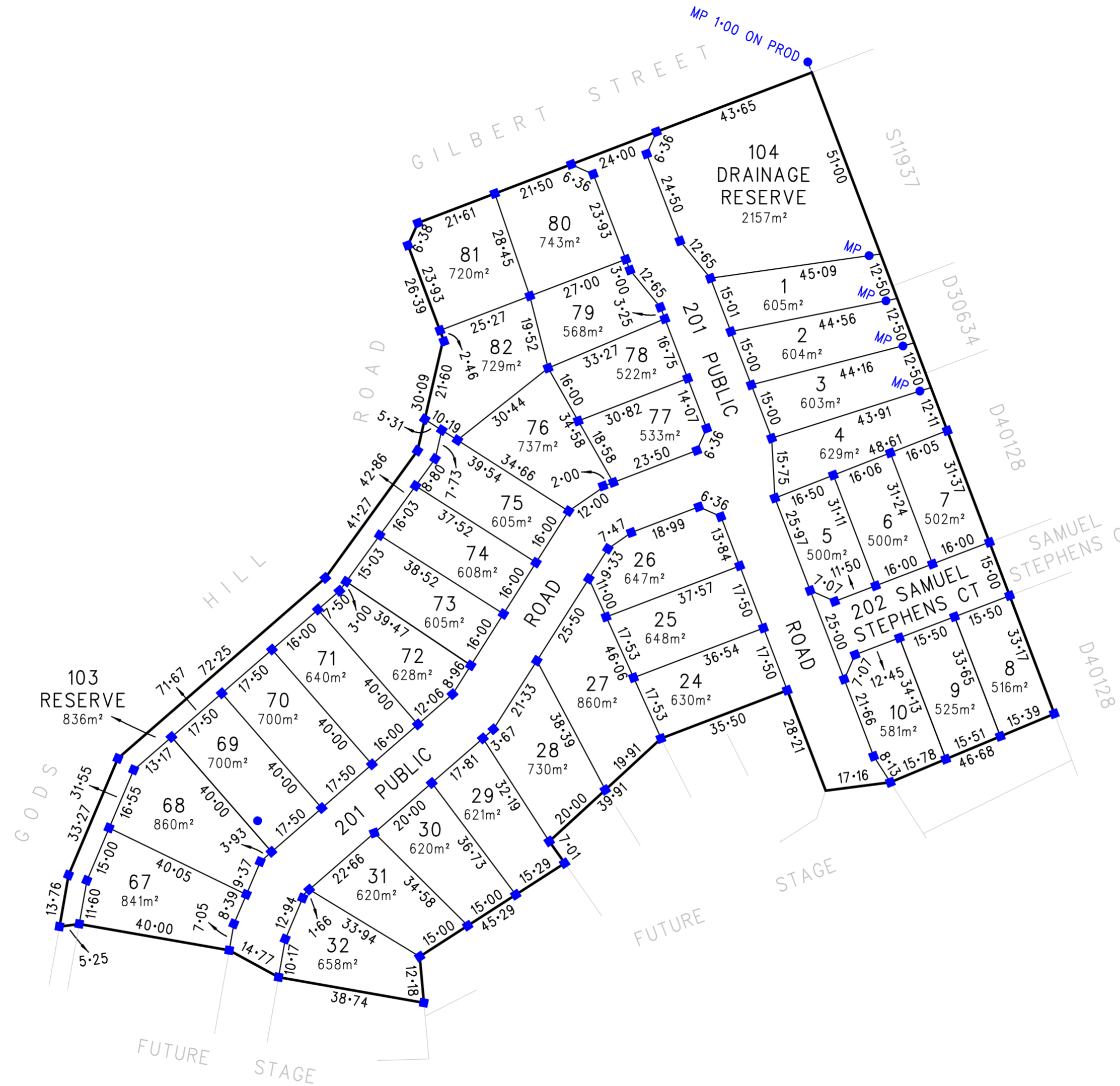

Andrew Davidson

PROPERTY
DEVELOPMENT
CONSULTANTS

PO Box 654
Glenside SA 5065

T 08 8390 0099

admin@andrewdavidson.com.au
www.andrewdavidson.com.au

ACN 007 904 396

DATE: 31/03/2023

OUR REF: 3554-PEG101.v2



I hereby certify that the land in this plan was surveyed by me on the 14th day of October 2022.

.....
Licensed Surveyor
PL12021